

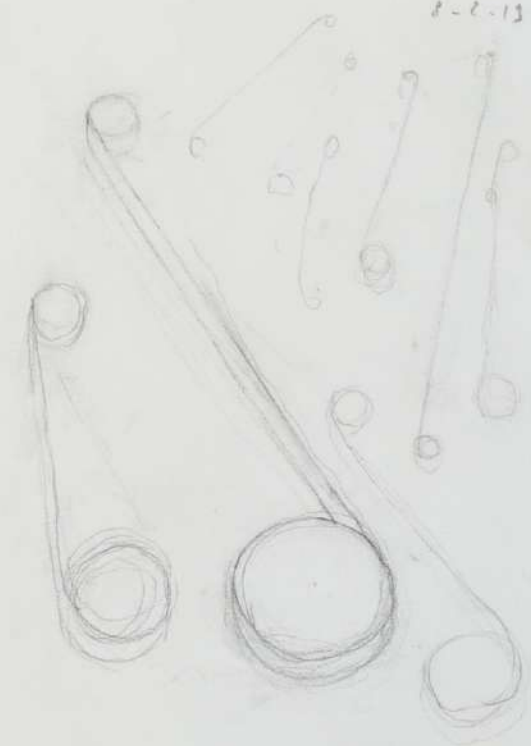

Ismail
Bahri

Exhibition Dates
22.02 to 04.04.2021

Preview Opening
21.02.2021 > 11 a.m

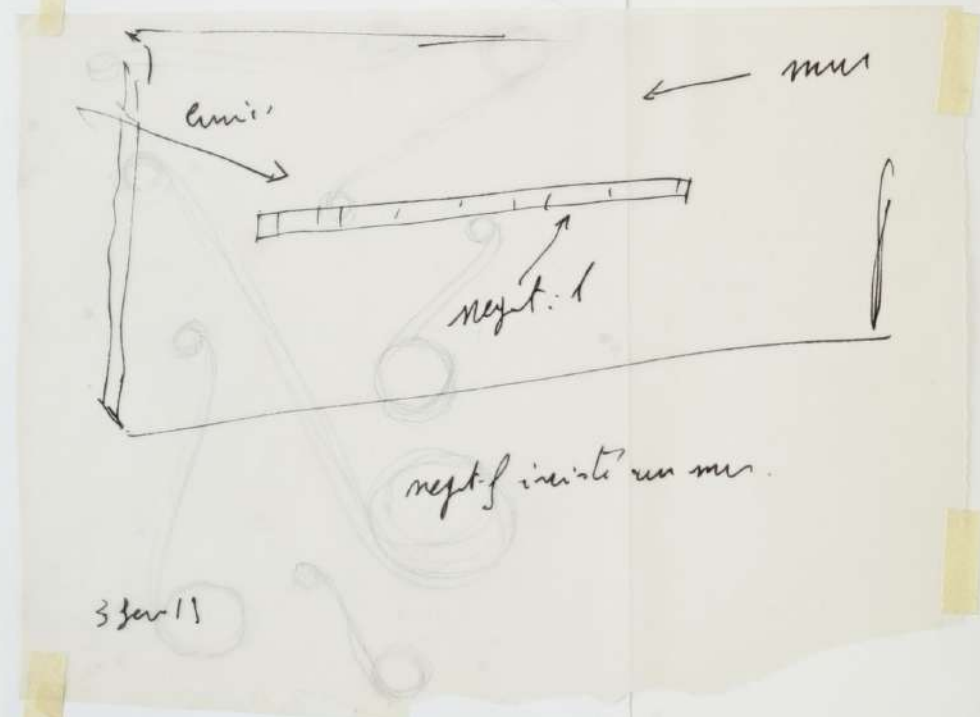
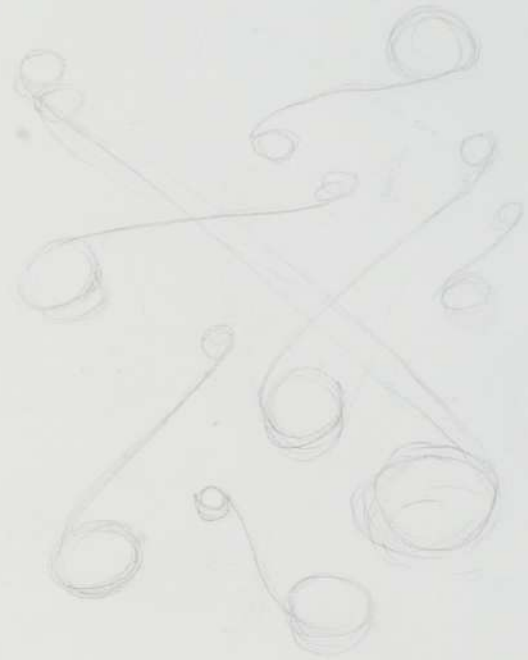



8.2.19

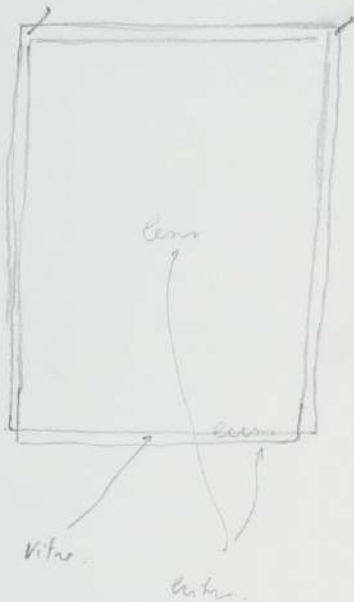

8.2.19

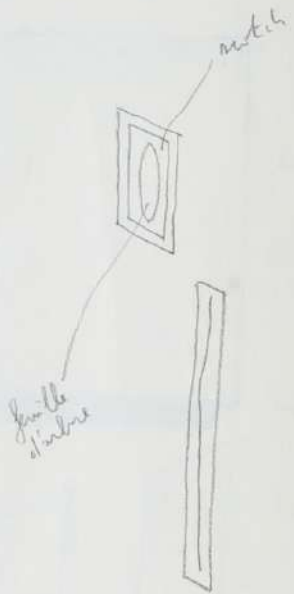

8 Jan 19 Paris

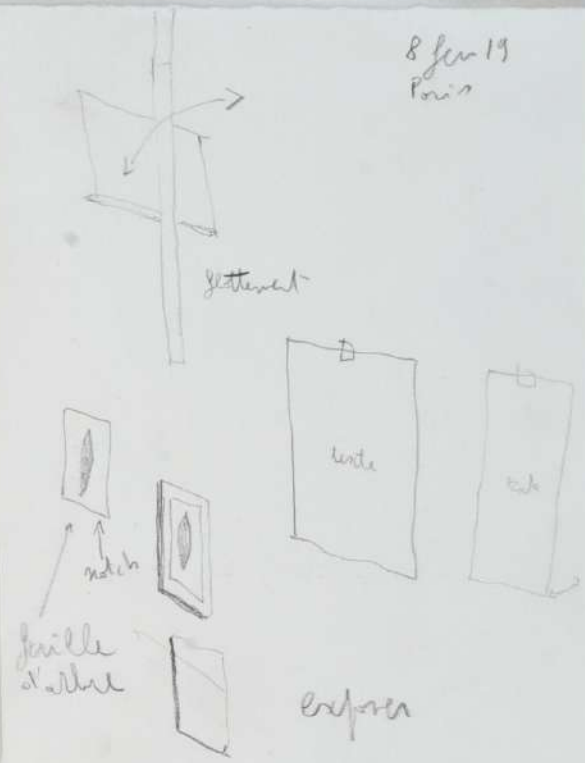

8 Jan 19 Paris

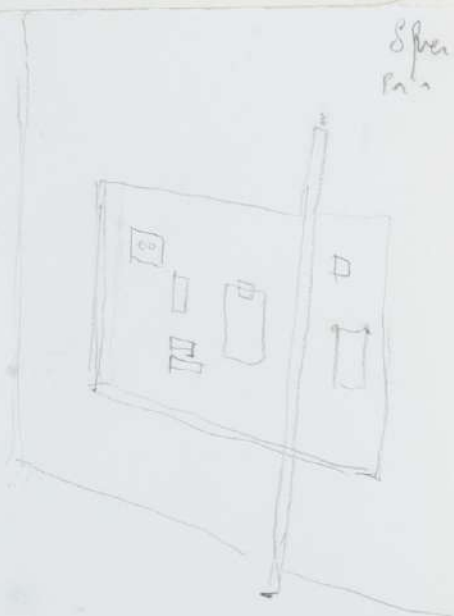

5.2.19

Reordigns. Recordings



8.2.19 Paris

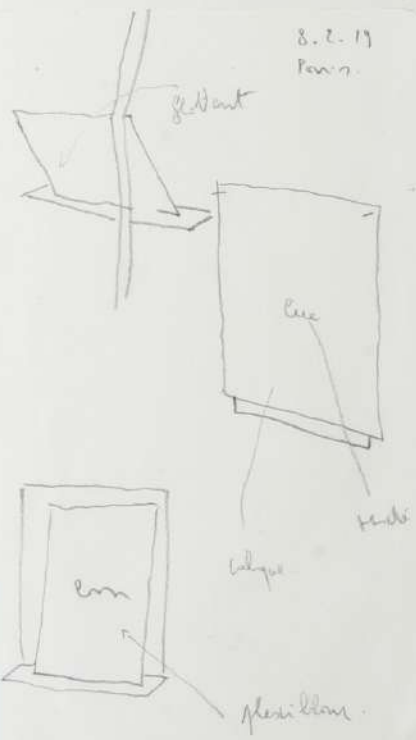

8 Jan 19 - Paris

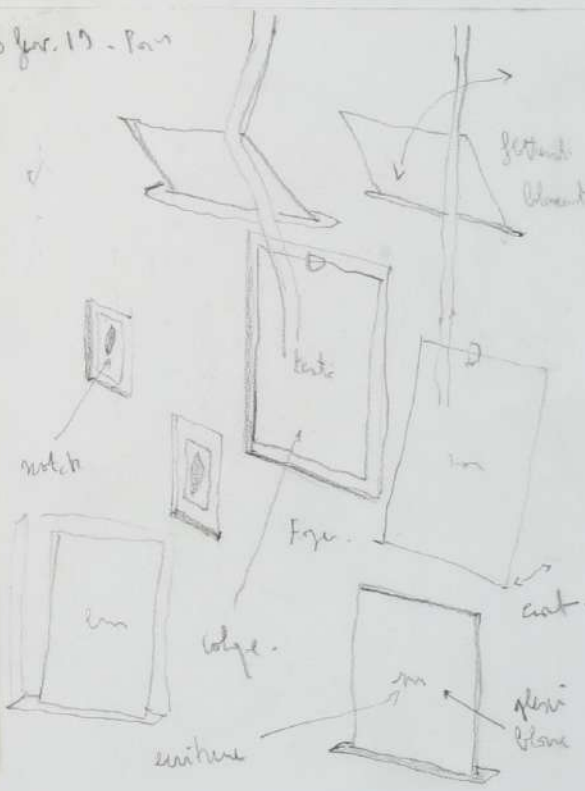

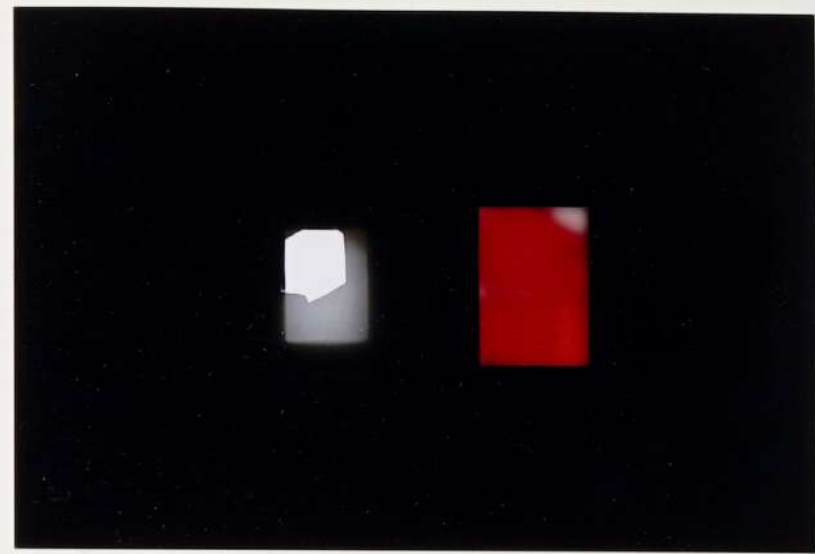
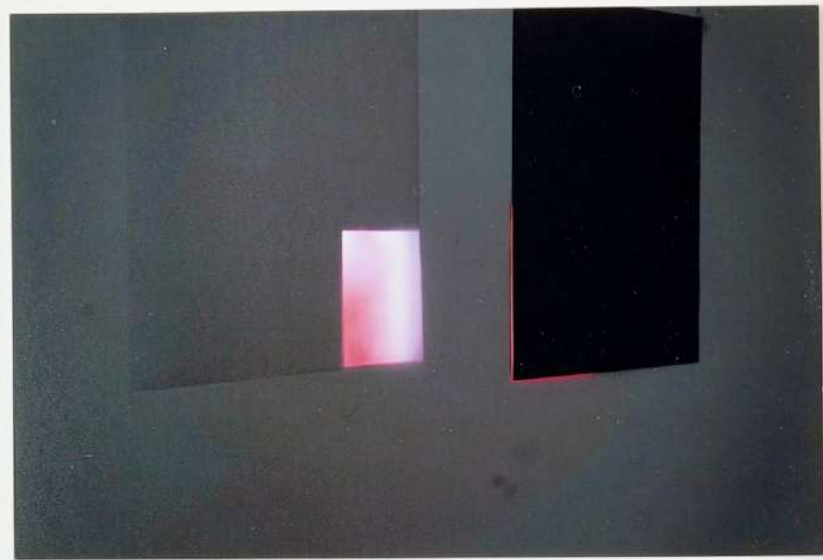
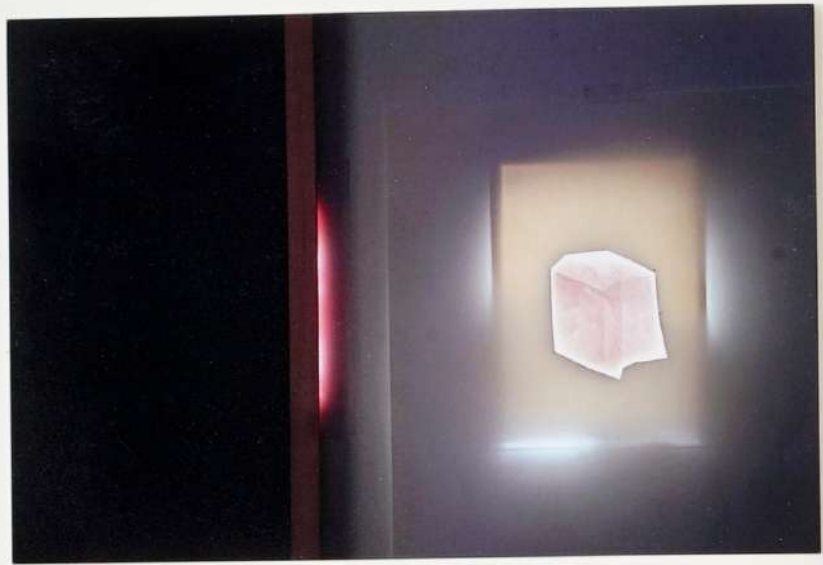

27.12.19
tunis.

Vitres
vitrines

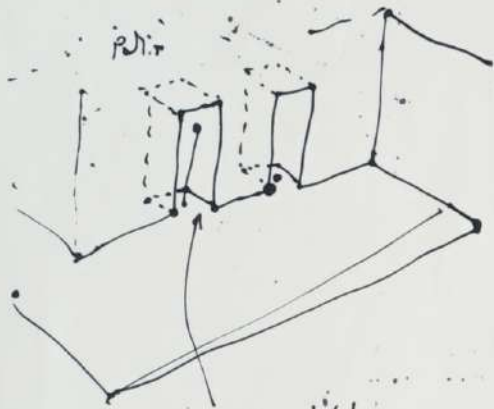

Utiliser Vitres
comme les vitrines
à gable shell.

ca. 9.12.19

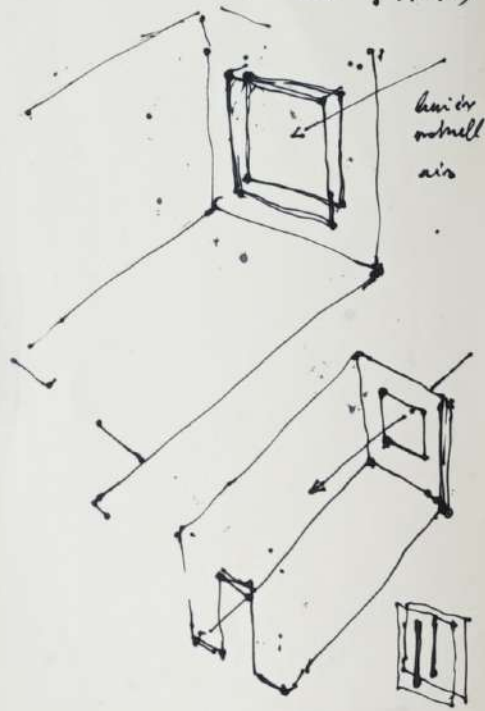

28.12.19

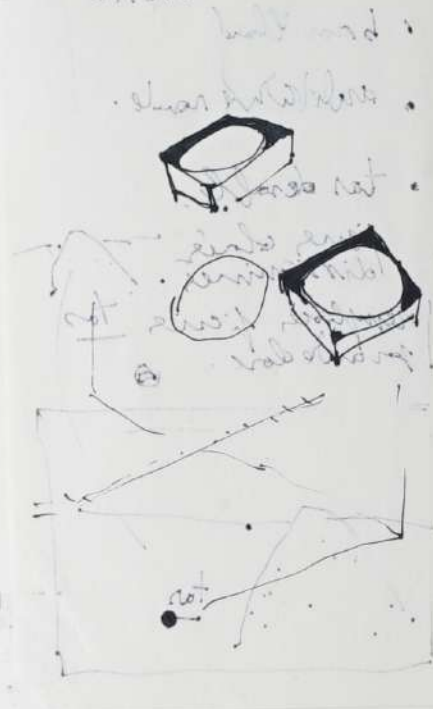

29 dec 19 tunis

nest.
boite - dans
un coin.

boite (boite)
polyèdre

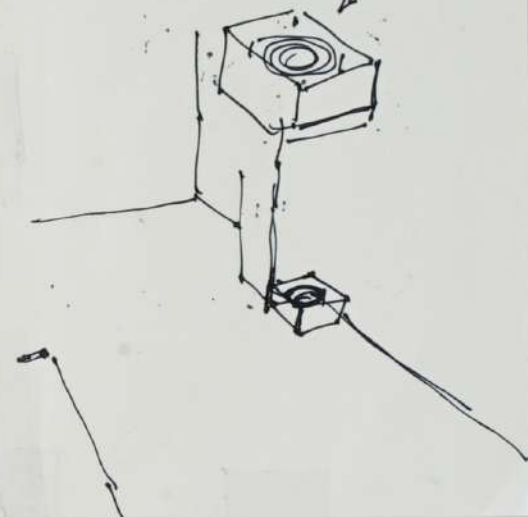

tunis. 26.11.19

objets
trous

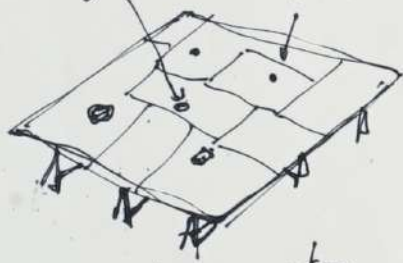

plan d'alignement.
jonction.
trous
cuviers.

26.12.19



26.12.19 tunis

face polygonale de la boîte en bois.
trous de la boîte

Le bois 6 mois sous
la pluie et le soleil.

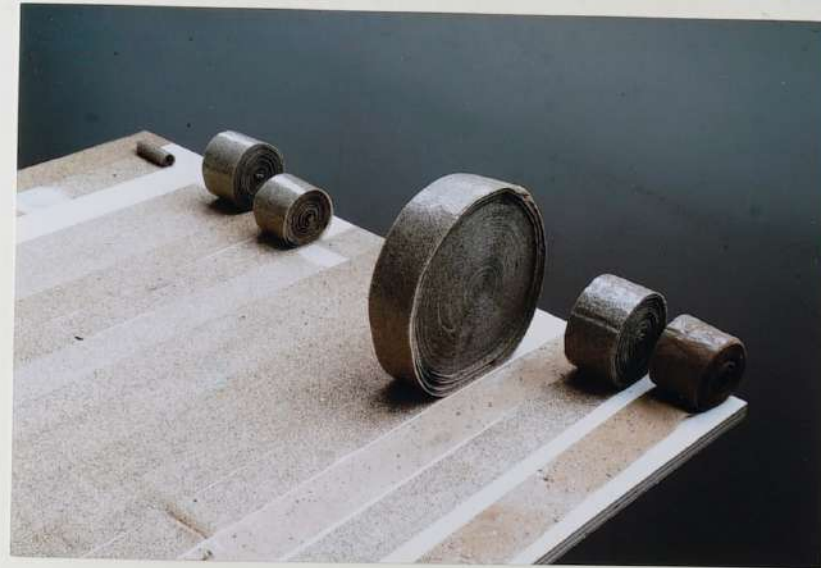

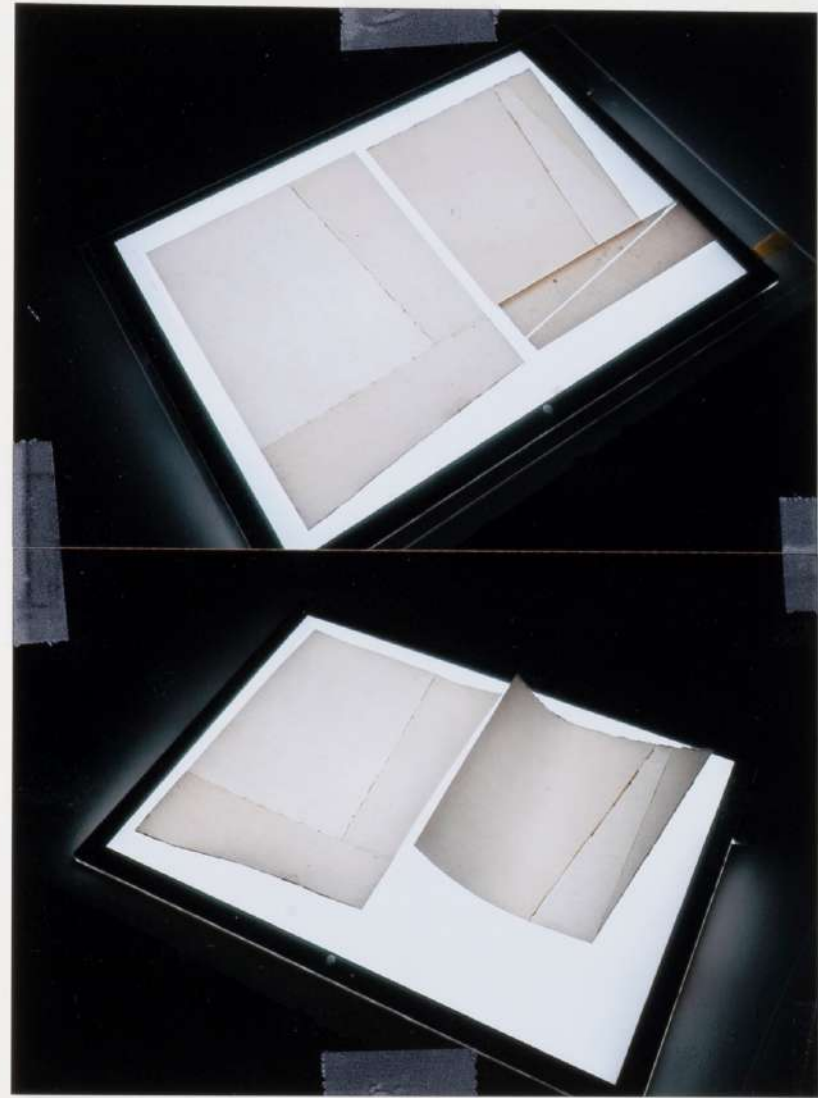



• edge
• base
all built



October 2019
TUNIS





Feb 15, 1971



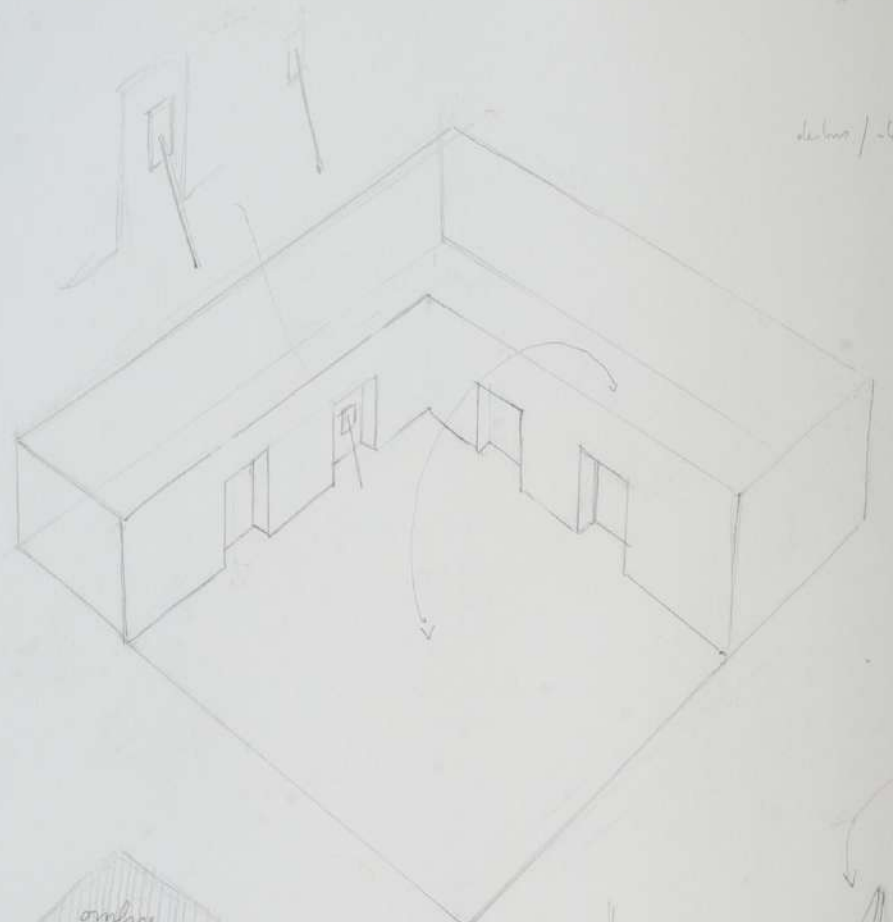

dehors / dehors

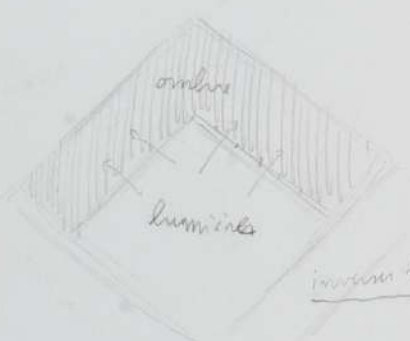

ombres

lumière

inconnu l'après



jours clos -
jours
jours



fenêtre / vitre

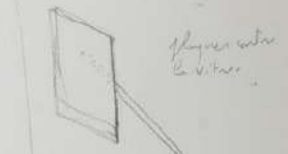

fenêtre vitre

vitre

Sambre

28.3.20
Mars

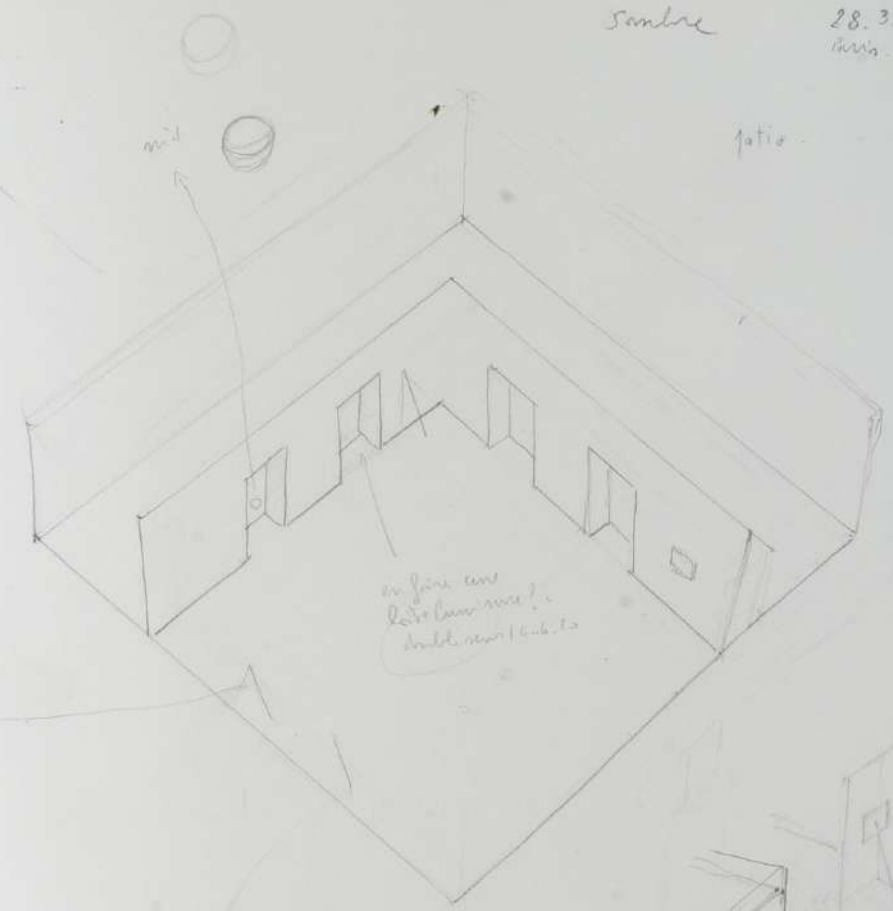

patio

en face une
table lumineuse?
dallage en bois

ombres / lumières

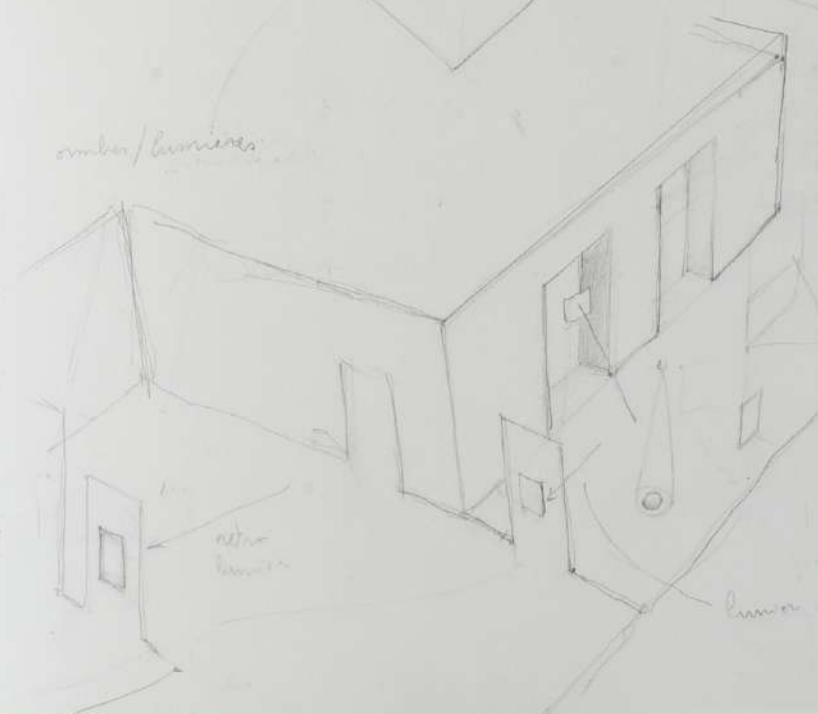

vitres vitres

portes

lumière



Ismail Bahri Biography

b. 1978, Tunis, Tunisia / Lives and Works between Paris and Tunis

The work of Ismaïl Bahri encompasses video, photographs and drawings. Interested in phenomenology, he captures small experiments in duration, scale, visibility and resolution. He observes what is happening and reacts accordingly, capturing gestures in the moment enables meaning to emerge outside the constraints of the frame. Working between mediums is a way to experiment more broadly and allow for the unexpected elements to appear and for alternative understandings to emerge. Ismail Bahri graduated with a Bachelor in Fine Art from Institut Supérieur des Beaux-Arts, Tunis and received an MA and earned a PhD from Panthéon-Sorbonne, Paris.

He has been recently exhibited at Fondation Hermès, Tokyo, Japan /Chateau de Nijo Jô, Kyoto, Japan / Centro Cultural Porto Seguro, Sao Paulo, Brazil / Jeu de Paume, Paris, France / Sharjah Art Foundation, Sharjah, UAE / Le Grand Café, Saint-Nazaire, France.

Bahri has screened his films at international film festivals including IFFR, Rotterdam, The Netherlands / TIFF, Toronto, Canada and FILMADRID, Madrid, Spain. Bahri's work forms part of many prestigious collections of art including Centre Georges Pompidou, Paris, France / MAC VAL, Vitry-sur-Seine, France / Centre National d'Arts Plastiques (CNAP), Paris, France / The Kamel Lazaar Foundation, Tunis, Tunisia / Saine Saint-Denis collection, France and Caldic Collectie, Rotterdam, The Netherlands.

Ismail Bahri est né en 1978 à Tunis en Tunisie. Il vit et travaille entre Paris et Tunis.

Le travail d'Ismail Bahri englobe la vidéo, la photographie et le dessin. Intéressé par la phénoménologie, il capture des expériences « petites » en durée, échelle, visibilité et résolution. Il observe ce qui se passe et réagit en conséquence, capturer les gestes à l'instant t, permet au sens, d'émerger hors des contraintes du cadre. Mixer les médiums est un moyen d'expérimenter plus largement et de permettre l'apparition d'éléments inattendue et l'émergence de compréhensions alternatives. Ismail Bahri est diplômé d'une Licence en Beaux-Arts de l'Institut Supérieur des Beaux-Arts de Tunis et a obtenu une maîtrise et un doctorat de Panthéon-Sorbonne, Paris.

Il a récemment été exposé à la Fondation Hermès, Tokyo, Japon / Château de Nijo Jô, Kyôto, Japon / Centro Cultural Porto Seguro, Sao Paulo, Brésil / Jeu de Paume, Paris, France / Sharjah Art Foundation, Sharjah, EAU / Le Grand Café, Saint-Nazaire, France.

Bahri a projeté ses films dans des festivals internationaux tels que l'IFFR, Rotterdam, les Pays-Bas / TIFF, Toronto, Canada et FILMADRID, Madrid, Espagne. Les œuvres de Ismaïl Bahri font partie de nombreuses collections d'art prestigieuses dont le Centre Georges Pompidou, Paris, France / MAC VAL, Vitry-sur-Seine, France / Centre National d'Arts Plastiques (CNAP), Paris, France / La Fondation Kamel Lazaar, Tunis, Tunisie / Collection Saine Saint-Denis, France et Caldic Collectie, Rotterdam, Pays-Bas.



info@selmaferiani.com
selmaferiani.com

(+216) 71 74 48 83
8 Place Sidi Hassine
2026 Sidi Bou Said Tunis

